



# belulu® Rebirth

美・ル・ル リバース

Manual

Thank you very much for purchasing this product. Please read this user's manual carefully before using the product. There is a guarantee certificate at the end of this document, so please make sure to store it in a safe place.

## Warning

- Make sure to use the right voltage, AC adapter, etc. by following the specifications in this document.
  - When using this product, do not look directly into the LED light, or point it toward your eyes. Looking directly into the LED may be harmful to the eyes.
  - Do not use this product if you find any problems with it, including any damages, faults, deformities, broken cables, etc.
  - If you notice any smoke, offensive smell, abnormal heat, etc. coming from the product, turn the power off and stop using it immediately.
  - Do not pull on the power adapter cable or touch the plug area with wet hands.
  - Do not leave or use this product or the power adapter in places that may be subject to high temperatures, such as stoves, etc.
  - Avoid using this product with wet hands, or when it is damp or covered in dirt, etc.
  - This product is not waterproof. Never use this product in places with high humidity, such as bathrooms, etc. This may cause burns, electric shocks, or product faults.
  - Do not subject the product to any strong actions such as by dropping or hitting it.
  - The product is fully charged within approximately 4 to 8 hours. Do not continue to charge it once it is fully charged.
  - Disconnect the charger cable from the product when it is not being charged.
  - Do not wash this product with water. If dry, take a damp cloth, wring it well, and use it to clean the product gently. Do not use solvents such as benzene, thinners, etc. to clean this product.
  - Any injuries, faults, damages, etc. caused to the product due to your failure to follow the important notes and warnings stated above, any incorrect use or disassembly/reassembly of the product, or any issues caused to the product or its accessories by these actions are not covered by the product guarantee, and the company shall bear no responsibility for them.
- (Danger)**
- Acute diseases ● Febrile illnesses ● Blood pressure disorders ● Infectious diseases ● Heart diseases ● Usage of medical electronic equipment (implanted medical devices, such as pacemakers, etc. electronic life-support equipment, such as heart-lung machines, etc.) or wearable medical electronic devices, such as wearable electrocardiogram devices, etc. ● History of skin cancer ● Skin disorders caused by diabetes or other diseases ● Currently pregnant ● Currently breast-feeding ● Skin conditions (atopic dermatitis) ● Skin inflammation due to overexposure to the sun, infected and inflamed acne, and sensitive skin due to allergic reactions) ● Dermatitis caused by cosmetics ● Generally not in good physical health ● Usage of long-term doses of steroid hormones drugs, etc.
- (Do not apply these parts)**
- Malignant tumors ● Cuts ● On bones or joints ● Areas with silicone due to plastic surgery, etc. ● Vocal cords area ● Delicate zones such as hair, around the eyes and ears, mucous membranes, etc.
- Please charge for 1 hour before the first time using ■

## After using

- Press the power button to turn it off.
- If the product is dirty, use a damp cloth to clean it.
- Avoid storing in places with high temperatures, high humidity, or under direct sunlight, as well as places that are highly dusty or within the reach of children.

This document promises to make the following repairs based on the following conditions. If you were to encounter a fault within the time period specified below from your date of purchase, you may make a repair request on presentation of this document.

## (Repair policy)

1. We would be happy to make repairs if a fault is encountered under normal usage based on the instructions given in this user's manual.
2. Repair requests for faults that have occurred during the product guarantee period may be made by presenting the product and this document.
3. Even if the product is still under the guarantee period, repairs would be chargeable under the following circumstances:
  - a. For any fault or damage caused by the incorrect use, unauthorized repair, or reassembly of the product.
  - b. For any fault caused after purchase during transit, transportation, or due to the product falling to the ground.
  - c. For any fault or damage caused by fire, earthquake, lightning, or any other natural disaster, as well as any public hazard or abnormal voltage.
  - d. If this document is not presented when requesting the repair.
  - e. If this document does not include the customer's name, date of purchase, or if this information has been rewritten over the top.
4. This document is valid in Japan only.

## (Warranty)

\*Only for the main device only

■ No.: \_\_\_\_\_ ■ Name: belulu Rebirth

■ Within 1 year from your date of purchase

■ Your name: \_\_\_\_\_

■ Address: \_\_\_\_\_

■ Order #: \_\_\_\_\_

Beautiful Angel Co., Ltd.  
Order date: \_\_\_\_\_

● When purchasing by mail order, it does not matter if this document does not include the purchase date or store stamp, as customers' information and purchase histories are generally managed by the store. However, your order number will be required when making an inquiry or requesting a repair, so please make sure to make a note of your order number in a safe place.

● This guarantee certificate constitutes our promise to make repairs based on the conditions and the guarantee period specified in this document. Therefore, (for the main device only) this guarantee certificate does not affect customers' statutory rights. Please contact us if you have any queries about repairs to be made outside of the guarantee

- Regardless of the number of times that the product has been used, if a repair request is made 3 months after the date of purchase, the customer shall be liable for the return postage fee.
- Outside of the guarantee period, if after diagnosis we consider that repairing the product would be feasible, you may request for such a repair to be executed subject to a repair fee.

Please feel free to contact us.  
TEL: +81-45-227-5121  
E-mail: shop@kireido.com

We accept a refund only for defective within 7 days.

ZIP: 231-0027  
Add: Beautiful Angel Co., Ltd.  
Re-lax building 6F Ougicho  
2-5-15, Naka-ku  
Yokohama, Kanagawa  
Japan

## Combination

- EMS/RF hyperthermia + Massage
- EMS/RF hyperthermia + LED(PHOTON)

Electroporation and Mesotherapy, will work automatically when using EMS/RF mode. It is not possible to use the Electroporation and Mesotherapy separately.

## Specification

\*There is possibility to change without notice



**[Product Specification]**  
Charging Time: 4~8hours Input: 5V/0.5A  
Battery type: Lithium-ion  
Dimensions: 180x45x35(mm) Weight: 100g

**[User guide for the supplied AC adapter specification]**  
Power Input: 100~240V 50/60Hz 0.2A Power Output: 5V/1A

- Please charge battery at first.
- When charging, the red notification light will turn on.
- During charging the machine may become little hot, but it is normal.
- After charging, the color of the notification light will turn to green.
- In order to keep the battery well condition, even if you do not use, please charge the battery every month.
- If the operating time is short, there is a possibility that the battery life.



## Operation method

### ON/OFF button EMS/RF

- Press ON/OFF button to turn on the power.
- The intensity level will be gradually increased by pressing the ON/OFF button each time.
- It turns off the power by pressing ON/OFF after "Strong".
- Restart the machine to adjust the intensity.

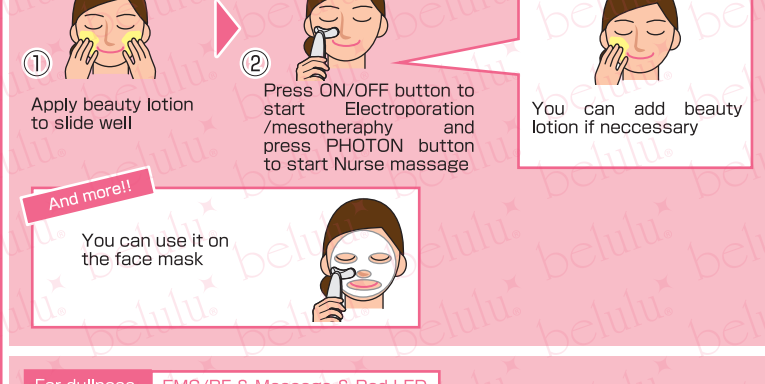

- Can use electroporation and mesotherapy synchronously.
- Press the PHOTON button when using EMS/RF mode.
- Detailed operation about nurse mode and PHOTON refers to the next page.

### PHOTON button LED/Massage

- Press ON/OFF button to turn on the power.
- Press the PHOTON button to switch each mode: Nurse → Red LED → Green LED → Blue LED → Mixed color LED.
- Press the PHOTON button to turn off the LED color after the mixed color LED.
- Press the PHOTON button again to change LED color or switch to other mode.

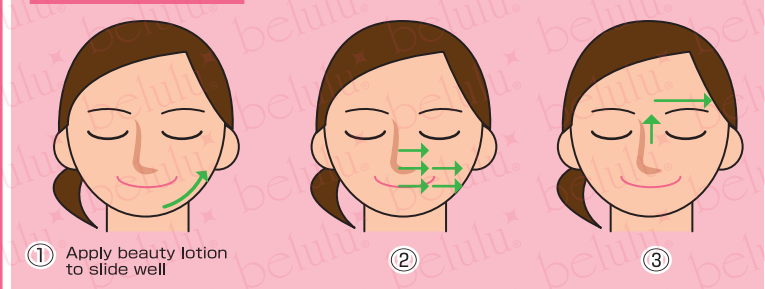

- Can use EMS/RF mode synchronously.
- Press ON/OFF button to start when using Nurse/LED mode.

### Timer function

Every face care mode is 10min. After 10min later it will turn off automatically.



When you press any button, the 10min countdown will restart.

- There may be some changes without notice.

## How to care

- Please do allergy test before using. \*Use all of the functions on your skin that appears inside of the gel.
- When using this product, do not look directly into the LED light, or point it toward your eyes. Looking directly into the LED may be harmful to the eyes.
- Use softly and slowly when massaging, do not rub your skin.
- Please do not use at sensitive, wet, oily and other special products.
- Please be sure to grasp the side metal parts to induce the weak current.
- If you notice any abnormal effect on your skin, stop using this product and consult your physician.
- After each care, please apply beauty lotion to the skin.

## Please refer to some recommended examples for daily care.

### Facial care EMS/RF mode

1. Apply beauty lotion to slide well
  2. Press the ON/OFF button to turn on the power and press again to start EMS/RF mode. Then slide softly and slowly
- You can add beauty lotion if necessary

### For dry skin Electroporation/mesotherapy+Nurse

1. Apply beauty lotion to slide well
  2. Press ON/OFF button to start Electroporation /mesotherapy and press PHOTON button to start Nurse massage
- You can add beauty lotion if necessary

And more!! You can use it on the face mask

### For dullness EMS/RF & Massage & Red LED

1. Apply beauty lotion to slide well
  2. Press ON/OFF button to start Electroporation /mesotherapy and press PHOTON button to start Nurse massage
- You can add beauty lotion if necessary

When use the LED light, close your eyes, and do not look LED for a long time.

### How to slide on face Left 5 minutes, Right 5 minutes, Total 10 minutes.



### Neck & Decollete



### Bust



### Buttocks

